

液压压力传感器 (非道路车辆) Hydraulics Pressure Sensor (Off-road)

产品介绍 Product Description

液压压力传感器测量液压系统内的压力信号。

Hydraulics Pressure Sensor detect the pressure in hydraulics system.

产品特征及优势 Feature and benefits

- ◆ 采用稳定可靠的压阻式微型应变片技术。
Robust and reliable piezoresistive Micro Strain Gauge technology.
- ◆ 0~60MPa 范围内, 压力量程可定制。
Pressure can be customized in the range of 0~60MPa.
- ◆ 优异的介质兼容特性。
Excellent compatibility of operation media.
- ◆ 模拟信号输出。
Analog Output.
- ◆ 防护等级可达到 IP67。
Protection degree with IP67.
- ◆ 接插件及压力接头可定制。
Connector and pressure port can be customized.

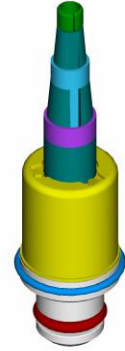

液压压力传感器
Hydraulics Pressure Sensor

产品作用 Application

检测液压系统内的压力, 用以闭环控制。

Detect the hydraulic pressure in the system for Closed-loop control.

操作 Operation

◆ 基本原理 Basic principle:

采用玻璃微熔工艺, 将压阻式微应变片烧结在不锈钢接头上, 当外界压力作用在不锈钢压力头上时, 硅应变片将随之产生形变, 而其电阻阻值将随形变产生变化, 经过调理电路处理, 电阻阻值将被转化为模拟信号。

With glass micro-melting process, piezoresistive micro strain gauge will be sintered on stainless steel port. When external pressure effect on the stainless steel port, silicon strain gauge will also be deformed, then its resistance value will change against the deformation. After conditioning, the resistance value will be converted into analog signal.

◆ 连接选项 Connection options:

根据客户选择定制连接系统。

Customized to connector and port.

◆ 包装选项 Packaging Options:

可提供定制包装以满足客户需要, 请联系KESENS技术部了解详情。

Custom packaging can be provided to meet customer requirement, please contact KESENS Engineering for details.

液压压力传感器 (非道路车辆) Hydraulics Pressure Sensor (Off-road)

技术参数 Functional Characteristics

参数 PARAMETER	符号 NOTE	最小值 MIN.	额定值 NOM.	最大值 MAX.	单位 UNITS
工作温度 TEMPERATURE RANGE	T	-40		100	°C
压力测量范围 PRESSURE RANGE	P	0		60	MPa
电源电压 SUPPLY VOLTAGE	Vcc		5 或 8-32		V
@过压保护 Overvoltage Protection				36	VDC
额定输出电压 NOMINAL OUTPUT	Vout	0.5		4.5	V
额定输出电流 NOMINAL OUTPUT	Iout	4		20	mA
过载压力 Proof pressure				2*P	MPa
爆破压力 Burst pressure				400	MPa
整体精度误差 OVERALL ACCURACY ERROR	Err		±1.5%FS @- 20° to 85°C		%FS
操作寿命 OPERATING ENDURANCE				10M	Cycles

可根据需要定制电气和环境规范, 详情请联系KESENS技术部。

Custom electrical and environmental specifications can be designed to meet any need, please contact KESENS Engineering for details.